



HENDI

Tools for Chefs

CHAFING DISH UNIQ

470411 v.02_s.01, 470428 v.02_s.01,
470435 v.02_s.01, 470442 v.02_s.01, 470459

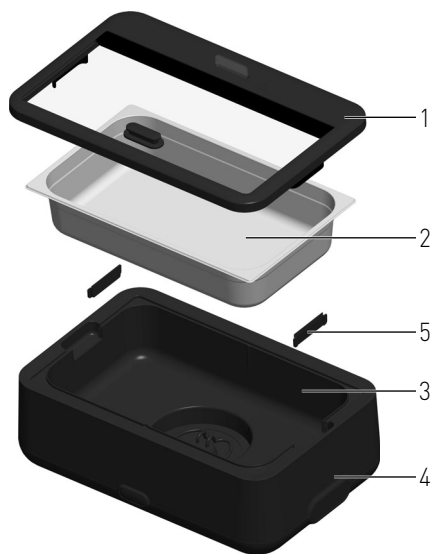

2

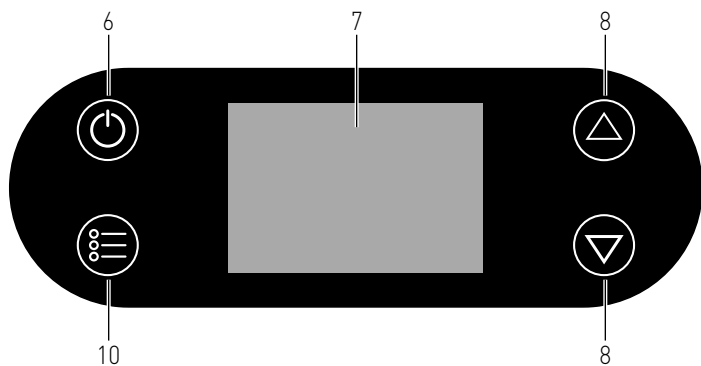

3

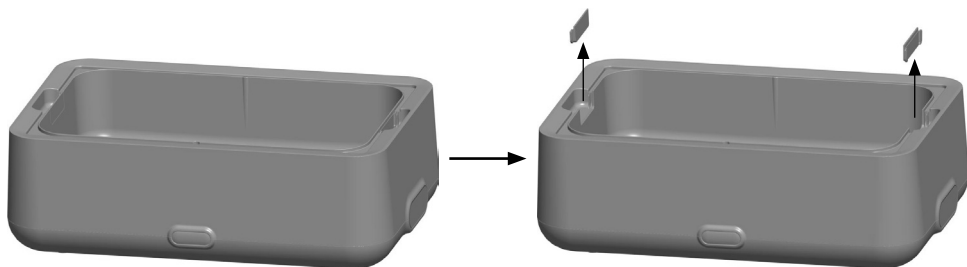

Dear Customer,

Thank you for purchasing this HENDI appliance. Read this user manual carefully, paying particular attention to the safety regulations outlined below, before installing and using this appliance for the first time.

Safety instructions

- Only use the appliance for the intended purpose it was designed for, as described in this manual.
- The manufacturer is not liable for any damage caused by incorrect operation and improper use.
-  **DANGER! RISK OF ELECTRIC SHOCK!** Do not attempt to repair the appliance by yourself. Do not immerse the electrical parts of the appliance in water or other liquids. Never hold the appliance under running water.
- **NEVER USE A DAMAGED APPLIANCE!** Check the electrical connections and cord regularly for any damage. When damaged, disconnect the appliance from the power supply. Any repairs should only be carried out by a supplier or qualified person to avoid danger or injury.
- **WARNING!** When positioning the appliance, route the power cable safely if necessary to avoid unintentional pulling, being damaged, coming into contact with the heating surface, or causing a tripping hazard.
- **WARNING!** As long as the plug is in the socket the appliance is connected to the power supply.
- **WARNING!** ALWAYS switch off the appliance before disconnecting from the power supply, cleaning, maintenance or storage.
- Only connect the appliance to an electrical outlet with the voltage and frequency mentioned on the appliance label.
- Do not touch the plug/electrical connections with wet or damp hands.
- Keep the appliance and electrical plug/connections away from water and other liquids. If the appliance falls into water, remove the power supply connections immediately. Do not use the appliance until it has been checked by a certified technician. Failure to follow these instructions will cause life threatening risks.
- Connect the power supply into an easily accessible electrical outlet so you can disconnect the appliance immediately in case of emergency.
- Make sure the cord does not come in contact with sharp or hot objects and keep it away from open fire. Never pull the power cord to unplug it from the socket, always pull the plug instead.
- Never carry the appliance by its cord.
- Never try to open the housing of the appliance yourself.
- Do not insert objects into the housing of the appliance.
- Never leave the appliance unattended during use.
- This appliance should be operated by trained personnel in kitchen of the restaurant, canteens or bar staff, etc.
- This appliance should not be operated by persons with reduced physical, sensory or mental capabilities, or persons that have a lack of experience and knowledge.
- This appliance should, under any circumstances, not be used by children.
- Keep the appliance and its electrical connections out of reach of children.

- Never use accessories or any extra devices other than those supplied with the appliance or recommended by the manufacturer. Failure to do so could pose a safety risk to the user and could damage the appliance. Only use original parts and accessories.
- Do not operate this appliance by means of an external timer or remote-control system.
- Do not place the appliance on a heating object (gasoline, electric, charcoal cooker, etc.).
- Do not cover the appliance in operation.
- Do not place any objects on top of the appliance.
- Do not use the appliance near any open flames, explosive or flammable materials. Always operate the appliance on a horizontal, stable, clean, heat-resistant and dry surface.
- The appliance is not suitable for installation in an area where a water jet could be used.
- Leave a space of at least 20 cm around the appliance for ventilation during use.
- **WARNING!** Keep all ventilation openings on the appliance free from obstruction.

Special safety instructions

- This appliance is intended for commercial use.
-  **CAUTION! RISK OF BURNS! HOT SURFACES!** The temperature of the accessible surfaces are very high during use. Touch only the control panel, handles, switches, timer control knobs or temperature control knobs.
- If the supply cord is damaged, it must be replaced by a special cord or assembly available from the manufacturer or its service agent.
- **ATTENTION!** Do not fill water over MAX level or below MIN level.
- Never use this appliance without water.
- Avoid boiling dry. This appliance is secured against boiling dry by an overheating protection.
- This overheating protection turns off the appliance automatically. In that case, let the appliance cool down completely before using it again.

Intended use

- This appliance is intended to be used for commercial applications, for example in kitchens of restaurants, canteens, hospitals and in commercial enterprises such as bakeries, butcheries, etc., but not for continuous mass production of food.
- The appliance is designed only for keeping the preheated soup/food warm. Any other use may lead to damage of the appliance or personal injury.
- Operating the appliance for any other purpose shall be deemed a misuse of the device. The user shall be solely liable for improper use of the device.

Grounding installation

This appliance is classified as **protection class I** and must be connected to a protective ground. Grounding reduces the risk of electric shock by providing an escape wire for the electric current. This appliance is fitted with a power cord with grounding plug or electrical connections with grounding wire. The connections must be properly installed and grounded.



Main parts of the product

(Fig.1 on page 4)

1. Lid
2. Soup/food pan
3. Water pot
4. Housing
5. Baffle plate

Remark: The content of this manual applies for all listed items unless specified otherwise. The appearance may vary from the shown illustrations.

Control panel

(Fig.2 on page 5)

6. ON/OFF button
7. Display panel
8. Up button
9. Down button
10. Temperature setting button

Preparation before use

- Remove all protective packaging and wrapping.
- Check that the device is in good condition and with all accessories. In case of incomplete or damaged delivery, please contact the supplier immediately. In this case, do not use the device.
- Clean the accessories and the appliance before use (See ==> Cleaning & Maintenance).
- Make sure the appliance is completely dry.
- Place the appliance on a horizontal, stable and heat resistant surface that is safe against water splashes.
- Keep the packaging if you intend to store your appliance in the future.
- Keep the user manual for future reference.

NOTE! Due to manufacturing residues, the appliance may emit a light odor during the first few uses. This is normal and does not indicate any defect or hazard. Make sure the appliance is well ventilated.

Operating instructions

1. Fill the water pot above MIN mark and below MAX mark
2. Fill the soup/food pan, for soup kettle not over the MAX mark.
3. Connect the appliance to power supply. One beep sound will be heard.
4. Enter to preparation mode by pressing the ON/OFF button, the display panel shows the last setting temperature.
5. Press "Up" or "Down" button, the appliance is heating (heating mode). The upper row of display panel shows the current water temperature, the lower row shows operating time - 00:00 (hours : minutes).
6. Adjust the set temperature by pressing "Temperature setting" button, display shows last set temperature. Press "Up" or "Down" button to adjust the temperature by 1°C interval.
7. The temperature will be set automatically after 3s and return to heating mode.

NOTE:

- Fill the preheated soup/food only.
- Default temperature setting at the first time is 85°C.
- Under temperature setting mode, press and hold "Up" or "Down" button for 3s to adjust the temperature rapidly by 1°C interval.
- Press ON/OFF button for 3s to turn off the appliance.

Compensation setting

1. In preparation mode, press and hold "Up" and "Down" buttons at the same time for 3s to enter temperature compensation mode.
2. The upper row of display panel shows the current compensation value, the lower row shows "COMP".
3. Press "Up" or "Down" button to adjust the value by 1°C interval.
4. The temperature will be set automatically after 3s and return to preparation mode.

NOTE:

- Default compensation temperature at the first time is 0.
- The compensation range is -10°C to 10°C.

Cleaning & maintenance

- **ATTENTION!** Always disconnect the appliance from the power supply and cool down before storage, cleaning & maintenance.
- Do not use water jet or steam cleaner for cleaning and do not push the appliance under the water as the parts will get wet and electric shock might be resulted.
- If the appliance is not kept in a good state of cleanliness, this can adversely affect the life of the appliance and result in a dangerous situation.

Cleaning

- Take out the baffle plate to drain out condensed water from handle to the water pot (See Fig.3 on page 5).
- Clean the cooled exterior surface with a cloth or sponge slightly dampened with a mild soap solution.
- For reasons of hygiene, the appliance should be cleaned before and after use.
- Avoid water contacting the electrical components.
- Clean the inside of container with a non-abrasive detergent and rinse with clean water.
- Clean and descale the boiler base at regular intervals (see chapter "Descaling")
- No parts are dishwasher safe.

Maintenance

- Check the operation of the appliance regularly to prevent serious accidents.
- If you see that the appliance is not working properly or that there is a problem, stop using it, switch it off and contact the supplier.
- All maintenance, installation and repair work must be carried out by specialised and authorised technicians, or recommended by the manufacturer.

Transportation and Storage

- Before storage, always make sure that the appliance has been disconnected from the power supply and completely cooled down.
- Store the appliance in a cool, clean and dry place.
- Never place heavy objects on the appliance as this could damage it.
- Do not move the appliance while it is under operation. Disconnect the appliance from power supply when moving and hold it at the bottom.



Descaling

This appliance should be cleaned and descaled frequently. To keep this appliance in optimum condition and to ensure its operation, it is crucial that you descale the appliance on a regular basis. Depending on the hardness of the water and the frequency of use, you need to repeat the following procedure regularly.

To descale use a descaling agent that is suitable for the appliance. You can also use pure lemon juice, citric acid or cleaning vinegar as a descaling agent. To ensure the proper mixture, read the instructions supplied with the agent. For pure lemon juice or cleaning vinegar the general mixture applies of 1/3 cleaning vinegar or lemon juice to 2/3 water.

1. Pour the solution in the boiler to maximum the "MAX" level.
2. Heat the solution by maximum temperature for 15mins.
3. Wait to allow the solution to loosen the build-up.
4. Rub lightly and gently with a brush with soft bristles.
5. Drain off the dirty water.
6. Repeat steps 1~5 until build-up has been removed.
7. Use a dry cloth to wipe the solution away.
8. When you drain off dirty water, leave the tap open and rinse the boiler with clean water till taste and smell are completely gone.
9. Now you can use the appliance again.

NOTE! Warranty is void if failure to descale regularly leads to reduced functioning or failure of the appliance.

Troubleshooting

If the appliance does not function properly, please check the below table for the solution. If you are still unable to solve the problem, please contact the supplier/service provider.

Problem	Possible cause	Possible solution
Appliance does not work	No power at the socket	Check the fuse
	The plug is not plugged (correctly) into the power point	Check the plug
Appliance does not reach the set temperature	Heating element faulty	Contact the supplier
	Heating element fuse faulty	
The buttons do not response or no display	Control unit faulty	Contact the supplier

Error codes identification

Error code	Possible cause	Possible solution
E1	The temperature of the appliance is too high.	Clear all obstacles that around the appliance and clean the interior of water pot and food pan.
	The water add into water pot might over 95°C.	Unplug the appliance, wait until the appliance is completely cool down.
E2	The heating element stops working.	Contact the supplier
E3	The temperature sensor is broken.	Contact the supplier.

Warranty

Any defect affecting the functionality of the appliance which becomes apparent within one year after purchase will be repaired by free repair or replacement provided the appliance has been used and maintained in accordance with the instructions and has not been abused or misused in any way. Your statutory rights are not affected. If the appliance is claimed under warranty, state where and when it was purchased and include proof of purchase [e.g. receipt].

In line with our policy of continuous product development we reserve the right to change the product, packaging and documentation specifications without notice.

Discarding & Environment



When decommissioning the appliance, the product must not be disposed of with other household waste. Instead, it is your responsibility to dispose to your waste equipment by handing it over to a designated collection point. Failure to follow this rule may be penalized in accordance with applicable regulations on waste disposal. The separate collection and recycling of your waste equipment at the time of disposal will help conserve natural resources and ensure that it is recycled in a manner that protects human health and the environment.

For more information about where you can drop off your waste for recycling, please contact your local waste collection company. The manufacturers and importers do not take responsibility for recycling, treatment and ecological disposal, either directly or through a public system.